

# Bubble Tek Product Manual



**A Mini Agitator Designed by Hashtek**

# Bubble Tek Product Manual v1.21

---

## Introduction

Bubble Tek is the micro version of the Hashtek A-Series, designed for home enthusiasts and professionals running micro-batches. It is perfect for phenotype hunting and small-scale operations.

---

## Specifications

- **Capacity:**
    - 5 kg (11 lb) fresh frozen cannabis
    - 1 kg (2.2 lb) dry material
  - **Build Material:**
    - 304 Stainless Steel construction
    - 500-micron stainless steel mesh basket
  - **Motor:**
    - Powerful 3-phase AC motor and gearbox
    - Automated forward and reverse via Analog Control 2.0, leveraging machine learning for optimal agitation
  - **Power Options:**
    - Available in 110v (North America) and 220v (Europe)
  - **Safety Features:**
    - **E-stop** (motor stops immediately when pressed)
  - **Drainage:** Conical drain for easy water flow
  - **Additional Features:**
    - Viewport/lid
    - Recirculation inlet
    - Stainless Steel Mesh Basket (500 micron)
-

## Setup

1. **Unpacking:**
    - Upon receiving your Bubble Tek, check all components for any shipping damage.
  2. **Installation:**
    - Place Bubble Tek on a stable, flat surface.
      - i. **500lb Hydraulic Lift Cart** - The recommended option is to put the BubbleTek on a Hydraulic Lift cart. We have designed a lid holder that can be mounted on any Hydraulic lift cart by drilling through the handle.
      - ii. **Table + Step Ladder** - One option is to put your BubbleTek on a table and use a step ladder to access it, remove the lid, and remove the mesh basket
    - Connect the unit to the appropriate power source (110v for North America or 220v for Europe).
    - Attach the recirculation inlet if required.
    - Place the stainless steel mesh basket into the agitation tank.
  3. **First Use:**
    - Clean the interior with oxi clean, followed by rinsing with clean water.
    - Ensure all components, including the mesh basket, are securely installed.
    - Run a short test cycle without material to verify all systems are functioning properly.
- 

## Operation

1. **Material Loading:**
  - Pre-chill the vessel with cold water. We recommend putting ice in your collection vessel (or a pre chill vessel) and recirculating until the water is cold.
  - Ice use in the vessel should be minimal and only used to maintain cold water, not for the initial chilling. **Maximum 1 kg ice per run.**
  - For fresh frozen material: Load up to 5 kg (11 lbs) of material.
  - For dry material: Load up to 1 kg (2.2 lbs).
  - If pre-soaking for extended time periods you may need to manually break up the ice block that forms as it can overload the motor. Use a paddle or rod for this task.
  - **Do not use wash bags with BubbleTek.** Its stainless mesh basket serves as the wash bag, ensuring free-flow agitation. Wash cubes, designed for bottom agitation systems, are unnecessary and reduce yield and system effectiveness.
2. **Agitation Control:**
  - Use the Analog Control 2.0 dial to control agitation intensity. The system is pre-configured with machine learning based on our professional models.
  - The forward and reverse agitation is fully automated, ensuring consistency with minimal operator intervention.

- Start slow and gradually increase intensity to prevent material damage.
  - **The BubbleTek Power Knob (0-100)** automatically adjusts 7 key parameters, including spin time, speed ramps, and pauses between directional changes, to control the wash intensity. Higher settings deliver more vigorous agitation for tough washes, while lower settings provide gentle handling to preserve delicate trichomes. The system simplifies operation—just turn the knob to achieve the desired balance of power and precision.
3. **Safety Protocols:**
- **E-stop:** The motor will stop immediately if the E-stop is pressed. After using the E-stop, unplug and reconnect the unit to reset it. Make sure the E-stop is not depressed when the unit is plugged in. Only use E-stop for emergency stopping of the machine.
4. **Drainage:**
- The conical drain design ensures efficient drainage after each run.
5. **Recirculation:**
- Attach the recirculation inlet to the designated port for continuous water recirculation during agitation. This helps maintain water temperature and reduce ice consumption.
- 

## Cleaning & Maintenance

1. **Post-Use Cleaning:**
- Rinse the tank and mesh basket with clean water immediately after use to prevent resin buildup.
  - For deeper cleaning, use a mild detergent followed by a rinse with RO water. Unscented OxiClean is our recommended cleaner.
2. **Stainless Steel Care:**
- Polish the exterior with a stainless steel cleaner if desired.
  - Avoid using harsh chemicals or abrasives (such as steel wool) on the inside of the tank or on the mesh basket.
3. **Mesh Basket Maintenance:**
- Check the 500-micron mesh regularly for any blockages or damage.
  - If the mesh becomes clogged, soak in a mild cleaning solution and rinse thoroughly.
  - Always store the mesh basket dry (do not store inside the tank with the lid on when not in use)
  - Easiest way to clean the mesh basket is to rinse the majority of the contaminants out using a garden hose/spray hose and then allow it to dry. Once dry any remaining biomass can easily be tapped out.
-

## Safety Instructions

- Always keep hands and foreign objects out of the tank while the agitator is operational.
  - Do not remove the lid or viewport during operation.
  - Ensure the E-stop is fully functional and test it regularly.
  - If using the unit in a wet or damp area, ensure that the power connections remain dry and secure.
- 

## Troubleshooting

1. **Motor Does Not Start:**
    - Ensure the unit is connected to the appropriate power source.
    - Check that the E-stop is not depressed (if it is twist to unlock and unplug the unit to reset)
    - Ensure the machine has not been overloaded. If there is a large chunk of frozen material use a paddle or long tool to break it up before turning on the agitator.
  2. **Agitation is Inconsistent:**
    - Verify that material is evenly distributed in the tank.
    - Adjust the Analog Control 2.0 dial to ensure proper settings.
  3. **Excessive Foaming:**
    - This may be caused by air entering the recirculation system. Ensure all connections are secure and make sure that you are not letting the pump run dry.
  4. **E-stop Activation:**
    - If the E-stop is pressed, the unit must be unplugged and reconnected to reset.
  5. **Breaker Keeps Tripping**
    - GFCI outlets are notorious for falsely tripping when used with VFDs (a speed controller for AC motors which the Hashtek systems use.
    - The easiest solution is not using a GFCI outlet.
    - If your code or facility requires the use of GFCI outlets speak with your electrician. The most common solution we have seen electricians use is hardwiring the unit to the wall with a disconnect box.
  6. **Excessive Slush Under Basket**
    - We recommend using no more than **1kg (2.2 lbs)** of ice per run. Ice should only be used to **maintain cold water temperature** during the process.
    - For optimal performance, the system should be filled with **pre-chilled water** before starting. A simple method for this is to use a **20-50 gallon pre-chill vessel**, where ice and water are combined to create the desired temperature. This ensures the system operates efficiently and minimizes ice consumption.
-

## Storage





- For short-term storage, rinse the tank and basket thoroughly and allow the system to air dry.
  - For long-term storage, perform a deep clean, remove all components, and store them in a dry environment.
  - Do not store with lid on as it can trap moisture. **Always keep the system dry**, especially the mesh basket.
- 

## Contact Information

For additional support or questions, visit our website at [hashtek.ca](https://hashtek.ca) or contact our customer service team at [support@hashtek.ca](mailto:support@hashtek.ca).

For fastest response time please ask your questions on our community forums <https://hashtek.ca/community/>

## Recommended Products:

Product	Image	Purpose	Purchase Link
Weiman Stainless Steel Cleaner and Polish		Keeps tanks looking shiny, removes water stains/fingerprints, prevents oxidation. Leaves a greasy layer, never use on inside of the tank.	<a href="https://www.amazon.com">Amazon.com</a> <a href="https://www.amazon.ca">Amazon.ca</a>
Bar Keepers Friend		Polishing powder for stainless. Great for removing oxidation if you stored your tank wet. Cleans and passivates your stainless. <b>A MUST HAVE.</b>	<a href="https://www.amazon.com">Amazon.com</a> <a href="https://www.amazon.ca">Amazon.ca</a>
Starsan Sanitizer		Run a dilute solution through the lines before storage to prevent microbial grown in the hoses.  Starsan dilution ratio is 6mL/Gallon for storage we recommend 4ml/Gallon for rinsing through hoses before storage	<a href="https://www.amazon.com">Amazon.com</a> <a href="https://www.amazon.ca">Amazon.ca</a>
Oxy Clean (unscented)		Great for general cleaning of the system or first time cleaning after getting your unit from the Hashtek factory. Can be flushed through hoses and pump. Rinse well	<a href="https://www.amazon.com">Amazon.com</a> <a href="https://www.amazon.ca">Amazon.ca</a>
Spin Scrubber		Great for cleaning tanks easily without having to put in elbow grease to scrub em down. Canadian dabs tek	<a href="https://www.amazon.com">Amazon.com</a> <a href="https://www.amazon.ca">Amazon.ca</a>



**Thick Hose = low pressure side.** Run from collection vessel to pump

**Thin Hose = high pressure side.** Run from pump to agitation tank

*The reason we do this is having the thinner hose after the pump increases pressure, making sure the pump always has enough pressure to actuate the check valve at the back of the tank.*





# Mini Legendary Bundle

See here for more information on the Hashtek Mini Legendary Bundle!

<https://hashtek.ca/product/mini-legendary-bundle/>

Note the green hose is a regular garden hose and is not included with the bundle so that you may get the specific length you need for your setup. The three way valve is placed directly after the pump as shown in the next page.



# Recirc Pump Kit

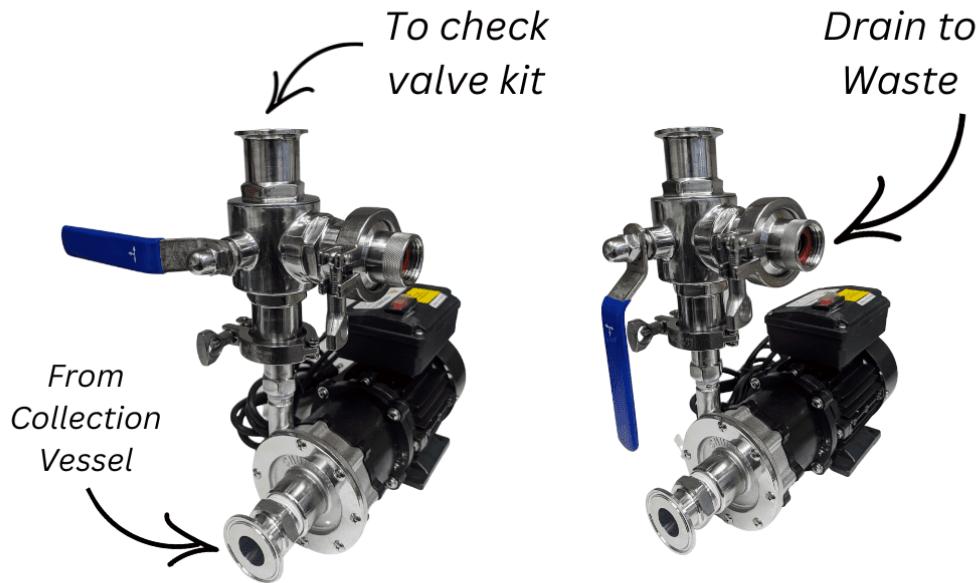

To check  
valve kit

Drain to  
Waste

From  
Collection  
Vessel

*3-way valve in:  
Recirc Mode*

*3-way valve in:  
Drain Mode*

The recirculation pump kit (included with the Legendary Mini Bundle) allows you to choose between draining to waste via a standard garden hose (not supplied) or recirculating back into the tank, depending on the position of the 3-way valve.

# Rinse Pump Kit

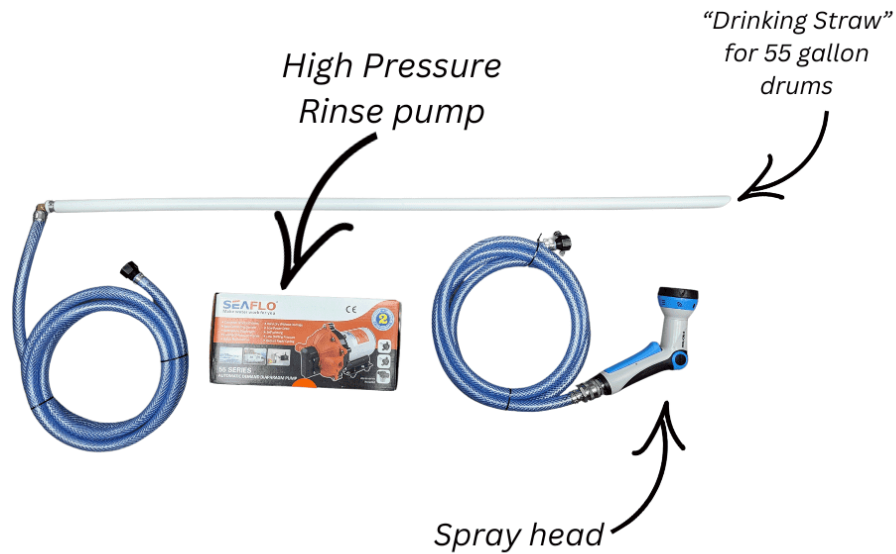

The "rinse pump kit" is available for purchase from the Hashtek website and is a great option for setting up an inexpensive rinse system with no drilling or bulkheads needed.

# Lid Holder



The lid holder is designed to bolt to most lift carts and can even be attached to a table. It give you a place to put the lid when loading and unloading the vessel

## Required



## Optional



Use a drill to create the two required holes. Drilling into a round pipe can be challenging, but applying tape to the surface can prevent the drill bit from slipping. Alternatively, clamp the holder to the pipe and drill through the pre-aligned holes to keep it steady.

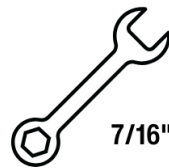
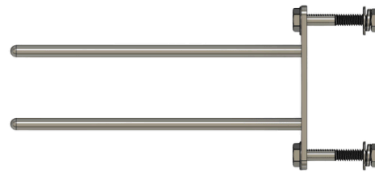
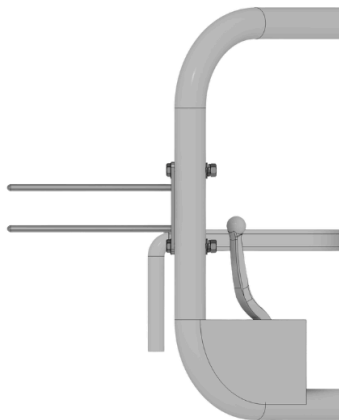

OR



**Bolt > Washer > Handle > Washer > Lock Washer > Nut**